

FREEMAN ELEMENTARY
INDOOR WALKING TRAIL

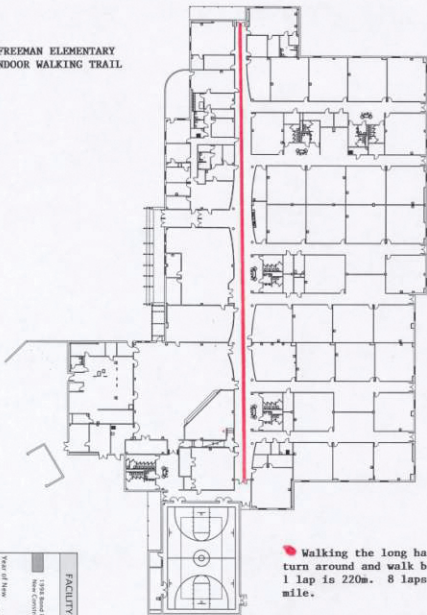

Walking the long hallway
turn around and walk back for
1 lap is 220m. 8 laps is a
mile.

FACILITY INFORMATION

1998 Bond Program
New Construction/ Addition
Year of New
Construction/ Addition
Floor Area (S.F.): 75,180



SJTB